

RXB阻燃扁式被漆功率瓷管电阻器

目 录

- 特性
- 结构图
- 规格尺寸
- 参考规格
- 功率、阻值范围与耐电压
- 额定温度下降曲线图
- 温升曲线
- 性能
- 料号编号

KKT RXB 阻燃扁式被漆功率瓷管电阻器

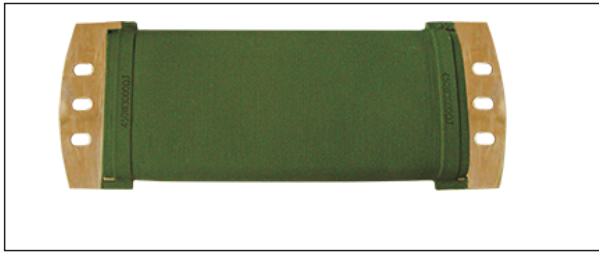

本体颜色: Body Color
 标准品: Standard (Green 绿色)
 标示: Marking
 (根据客户要求提供相应标识)
 (According to the customer request to provide corresponding identification)

特性 Features

- I 电阻表面被漆, 功率范围较宽 Surface painted, wide power range
- II 优良的高温负荷性能 Excellent high temperature load performance
- III 全焊接结构 Full-welded structure
- IV 产品具有较高的可靠性 High reliability
- V 绿色或灰色涂料包封, 文字标志, 可提供安装配件 (选购件)
 Imported grey and green coating, character marking assembly and fittings (available)
- VI 精度范围: $\pm 5\%$ 、 $\pm 10\%$. Resistance tolerance: $\pm 5\%$ 、 $\pm 10\%$

结构图 Construction

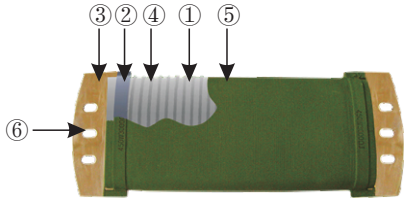

①	②	③
陶瓷基体	金属卡环	金属支架
Ceramic base	Iron snap ring	Metal support
④	⑤	⑥
绕线	绝缘涂料	安装接线端
Wire wound	Insulation coating	Installing terminal

规格尺寸 Dimensions

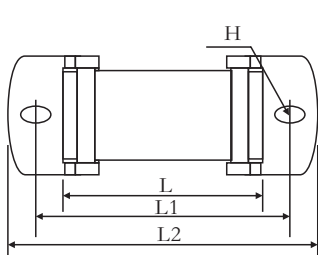

RXB 40W—280W

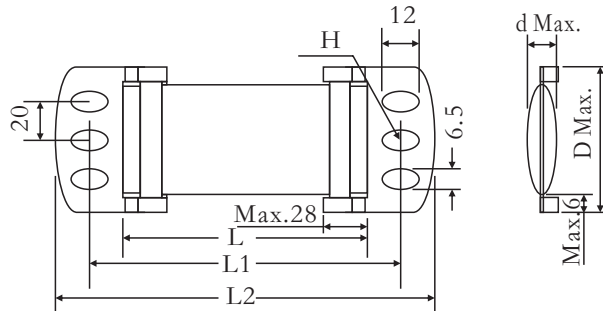

RXB 330W—1000W

规格 Type	功率 Power (W)	外形尺寸 Dimensions (mm)					
		$L \pm 1.5$	$L1 \pm 1.5$	$L2 \pm 1.5$	D(max.)	d(max.)	H(max.)
RXB	40	50	67	86	37	10	5.5X10
	60	80	97	116	37	10	5.5X10
	65	90	107	126	37	10	5.5X10
	70	100	117	136	37	10	5.5X10
	90	120	137	156	37	10	5.5X10
	110	153	169	188	37	10	5.5X10
	180	150	170	190	59	12	6.5X10
	225	200	220	240	59	12	6.5X10
	280	250	270	290	59	12	6.5X10
	330	210	238	266	96	25	6.5X12
	450	290	318	346	96	25	6.5X12
	600	390	418	446	96	25	6.5X12
	800	490	518	546	96	25	6.5X12
	1000	590	618	646	96	25	6.5X12

参考规格 Reference Standards

JIS C 5201-1

功率、阻值范围与耐电压 Power And Resistance etc

规格 Type	功率 Power(W)	阻值范围 Resistance Range(Ω)	误差值 Tolerance	温度系数 T.C.R PPM/ $^{\circ}$ C
RXB	40	0.1 Ω ~6K8 Ω	J \pm 5% K \pm 10%	-300PPM/ $^{\circ}$ C \leq TCR \leq +300PPM/ $^{\circ}$ C
	60	0.1 Ω ~15K Ω		
	65	0.1 Ω ~18K Ω		
	70	0.1 Ω ~22K Ω		
	90	0.1 Ω ~27K Ω		
	110	0.1 Ω ~33K Ω		
	180	0.1 Ω ~47K Ω		
	225	0.1 Ω ~68K Ω		
	280	0.1 Ω ~100K Ω		
	330	0.1 Ω ~7K5 Ω		
	450	0.1 Ω ~10K Ω		
	600	0.1 Ω ~15K Ω		
	800	0.1 Ω ~18K Ω		
	1000	0.1 Ω ~21K Ω		

额定温度下降曲线图 Derating Curve

例 Example

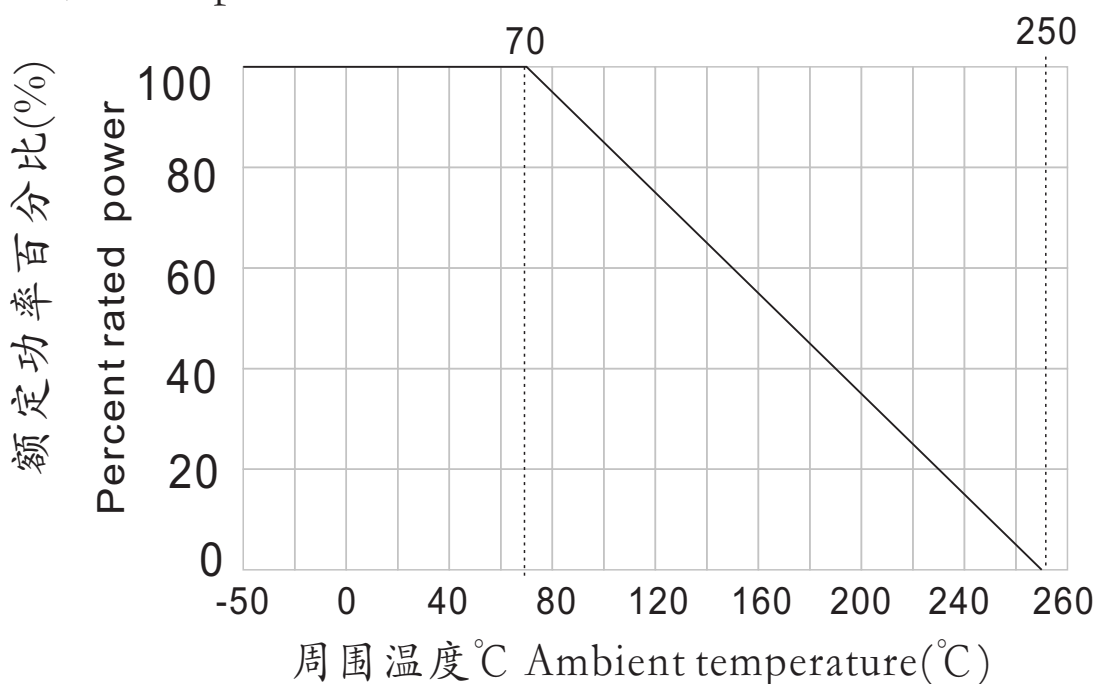

温升曲线 Temperature Rise Curve

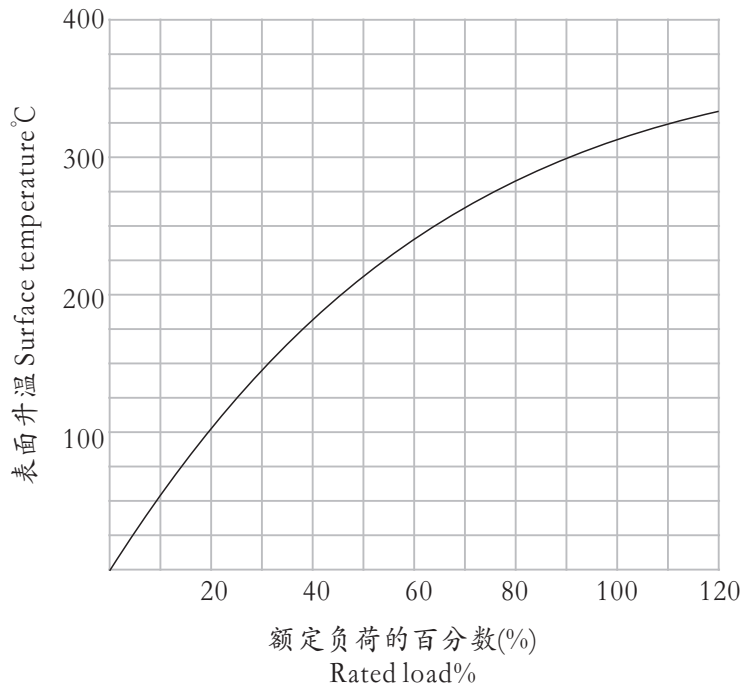

性能 Performance

试验项目 Test Items	性能 Performance	试验方法 Test Methods(JIS C 5201-1)
短时间负荷 Short-time overload	$\Delta R \leq \pm (2\%R_0 + 0.05\Omega)$	$\sqrt{10PR}$, 5S
引出端强度 Terminal tensile strength	$\Delta R \leq \pm (2\%R_0 + 0.05\Omega)$	45N, 30s
振动 Vibration	$\Delta R \leq \pm (2\%R_0 + 0.05\Omega)$	10HZ~55HZ~10HZ, 1.5mm, 2h
耐热性 Heat resistant	$\Delta R \leq \pm (2\%R_0 + 0.05\Omega)$	350 ± 5°C, 2h
热冲击 Thermal shock	$\Delta R \leq \pm (2\%R_0 + 0.05\Omega)$	\sqrt{PR} , 30min / -55°C, 15min
耐湿负荷 Humidifying-proof coad	$\Delta R \leq \pm (2\%R_0 + 0.05\Omega)$	40°C, RH93 ± 3%, 0.1PR, 500h
耐久性 Endurance	$\Delta R \leq \pm (2\%R_0 + 0.05\Omega)$	10~35°C, PR, 500h

料号编号 Ordering Information ^{±(5%R₀+0.05Ω)}

例 example

RXB	100W	J	100R0	A
产品名称 Product Name	功率Power	精度 Tol	标称阻值 Nominal value	特殊码 Special code
RXB	40W 60W 100W 1000W	J = ± 5% K = ± 10%	1R00 = 1Ω 100R0 = 100Ω 1KR0 = 1KΩ	A1 不带支架 A1 Without brackets A2 带支架 A2 With brackets